

Front Entrance



30 X 96 Table



Fire Extinguisher



36 X 96 Table

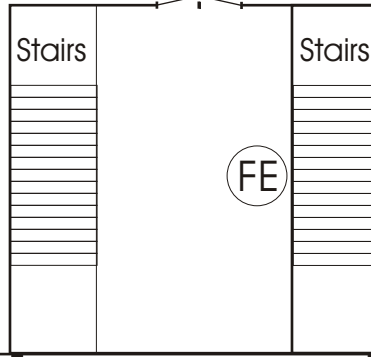

Stage and tables are to be left as shown in this diagram. Chairs are to be placed on top of the table with no more than 10 chairs per table. Chairs are to be placed with one chair upright and the other upside down on the upright chair.

Side Entrance

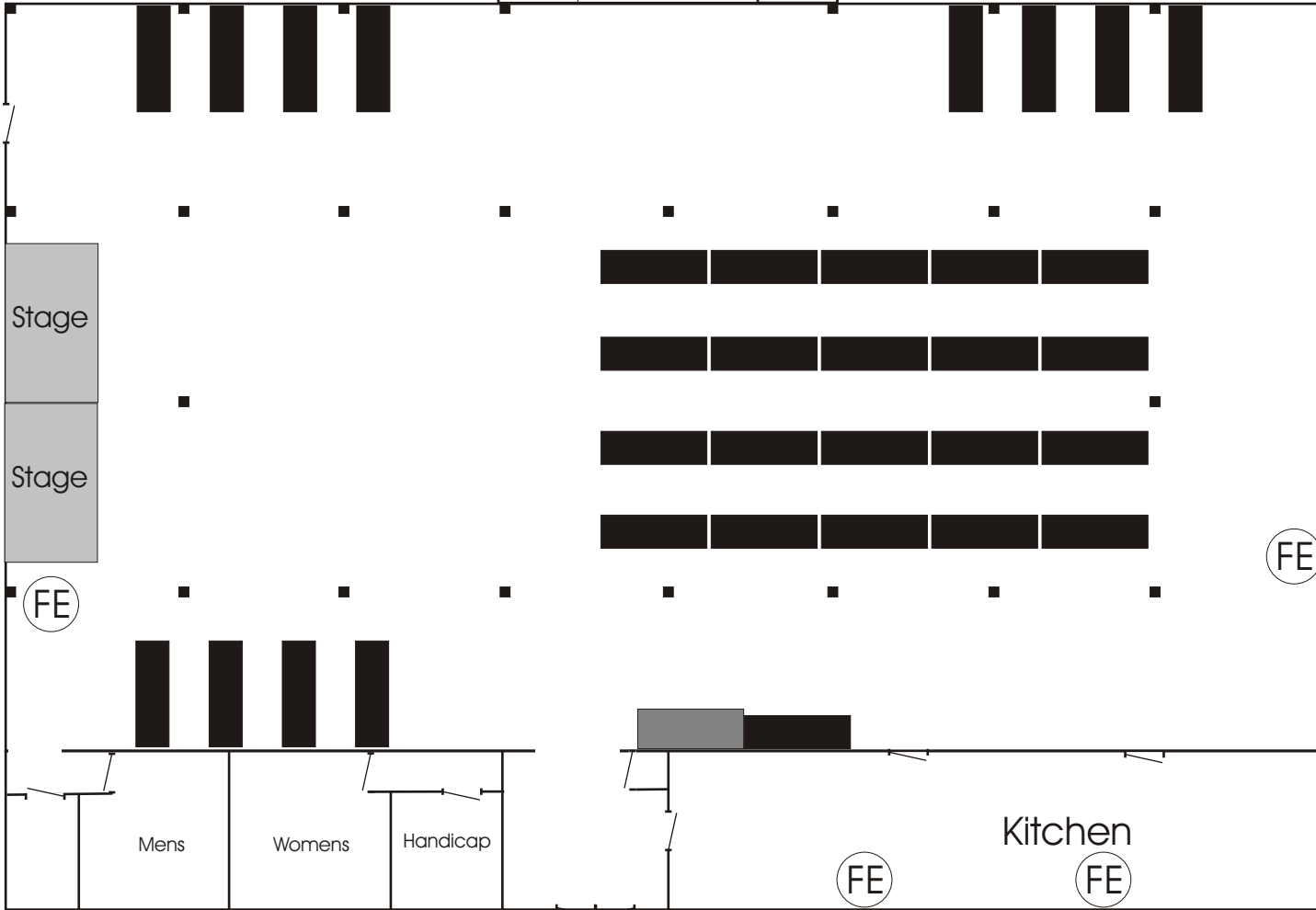

Side Entrance

Rear Entrance

Kitchen

Mens

Womens

Handicap

Stage

Stage